

PREVIOUS AREA	TOWER 1	TOWER 2	TOWER 3	TOWER 4	TOWER 5	TOWER 6A	TOWER 7	TOWER 8	TOWER 9	TOWER 10
AREA NO. 1	AREA NO. 2	AREA NO. 3	AREA NO. 4	AREA NO. 5	AREA NO. 6	AREA NO. 7	AREA NO. 8	AREA NO. 9	AREA NO. 10	AREA NO. 11
AREA NO. 12	AREA NO. 13	AREA NO. 14	AREA NO. 15	AREA NO. 16	AREA NO. 17	AREA NO. 18	AREA NO. 19	AREA NO. 20	AREA NO. 21	AREA NO. 22
AREA NO. 23	AREA NO. 24	AREA NO. 25	AREA NO. 26	AREA NO. 27	AREA NO. 28	AREA NO. 29	AREA NO. 30	AREA NO. 31	AREA NO. 32	AREA NO. 33
AREA NO. 34	AREA NO. 35	AREA NO. 36	AREA NO. 37	AREA NO. 38	AREA NO. 39	AREA NO. 40	AREA NO. 41	AREA NO. 42	AREA NO. 43	AREA NO. 44
AREA NO. 45	AREA NO. 46	AREA NO. 47	AREA NO. 48	AREA NO. 49	AREA NO. 50	AREA NO. 51	AREA NO. 52	AREA NO. 53	AREA NO. 54	AREA NO. 55
AREA NO. 56	AREA NO. 57	AREA NO. 58	AREA NO. 59	AREA NO. 60	AREA NO. 61	AREA NO. 62	AREA NO. 63	AREA NO. 64	AREA NO. 65	AREA NO. 66
AREA NO. 67	AREA NO. 68	AREA NO. 69	AREA NO. 70	AREA NO. 71	AREA NO. 72	AREA NO. 73	AREA NO. 74	AREA NO. 75	AREA NO. 76	AREA NO. 77
AREA NO. 78	AREA NO. 79	AREA NO. 80	AREA NO. 81	AREA NO. 82	AREA NO. 83	AREA NO. 84	AREA NO. 85	AREA NO. 86	AREA NO. 87	AREA NO. 88
AREA NO. 89	AREA NO. 90	AREA NO. 91	AREA NO. 92	AREA NO. 93	AREA NO. 94	AREA NO. 95	AREA NO. 96	AREA NO. 97	AREA NO. 98	AREA NO. 99
AREA NO. 100	AREA NO. 101	AREA NO. 102	AREA NO. 103	AREA NO. 104	AREA NO. 105	AREA NO. 106	AREA NO. 107	AREA NO. 108	AREA NO. 109	AREA NO. 110

PREVIOUS AREA	TOWER 1	TOWER 2	TOWER 3	TOWER 4	TOWER 5	TOWER 6A	TOWER 7	TOWER 8	TOWER 9	TOWER 10
AREA NO. 1	AREA NO. 2	AREA NO. 3	AREA NO. 4	AREA NO. 5	AREA NO. 6	AREA NO. 7	AREA NO. 8	AREA NO. 9	AREA NO. 10	AREA NO. 11
AREA NO. 12	AREA NO. 13	AREA NO. 14	AREA NO. 15	AREA NO. 16	AREA NO. 17	AREA NO. 18	AREA NO. 19	AREA NO. 20	AREA NO. 21	AREA NO. 22
AREA NO. 23	AREA NO. 24	AREA NO. 25	AREA NO. 26	AREA NO. 27	AREA NO. 28	AREA NO. 29	AREA NO. 30	AREA NO. 31	AREA NO. 32	AREA NO. 33
AREA NO. 34	AREA NO. 35	AREA NO. 36	AREA NO. 37	AREA NO. 38	AREA NO. 39	AREA NO. 40	AREA NO. 41	AREA NO. 42	AREA NO. 43	AREA NO. 44
AREA NO. 45	AREA NO. 46	AREA NO. 47	AREA NO. 48	AREA NO. 49	AREA NO. 50	AREA NO. 51	AREA NO. 52	AREA NO. 53	AREA NO. 54	AREA NO. 55
AREA NO. 56	AREA NO. 57	AREA NO. 58	AREA NO. 59	AREA NO. 60	AREA NO. 61	AREA NO. 62	AREA NO. 63	AREA NO. 64	AREA NO. 65	AREA NO. 66
AREA NO. 67	AREA NO. 68	AREA NO. 69	AREA NO. 70	AREA NO. 71	AREA NO. 72	AREA NO. 73	AREA NO. 74	AREA NO. 75	AREA NO. 76	AREA NO. 77
AREA NO. 78	AREA NO. 79	AREA NO. 80	AREA NO. 81	AREA NO. 82	AREA NO. 83	AREA NO. 84	AREA NO. 85	AREA NO. 86	AREA NO. 87	AREA NO. 88
AREA NO. 89	AREA NO. 90	AREA NO. 91	AREA NO. 92	AREA NO. 93	AREA NO. 94	AREA NO. 95	AREA NO. 96	AREA NO. 97	AREA NO. 98	AREA NO. 99
AREA NO. 100	AREA NO. 101	AREA NO. 102	AREA NO. 103	AREA NO. 104	AREA NO. 105	AREA NO. 106	AREA NO. 107	AREA NO. 108	AREA NO. 109	AREA NO. 110

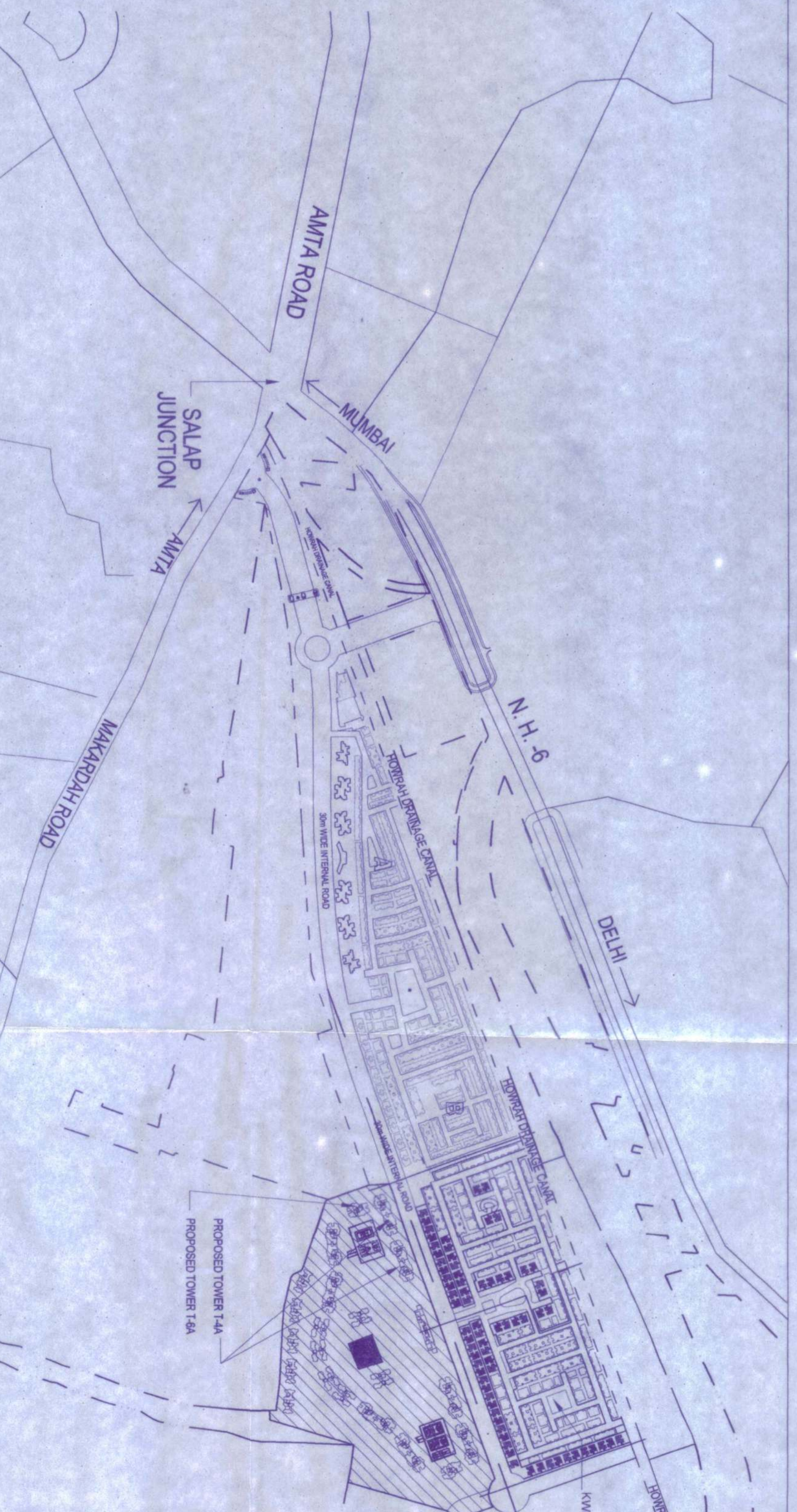
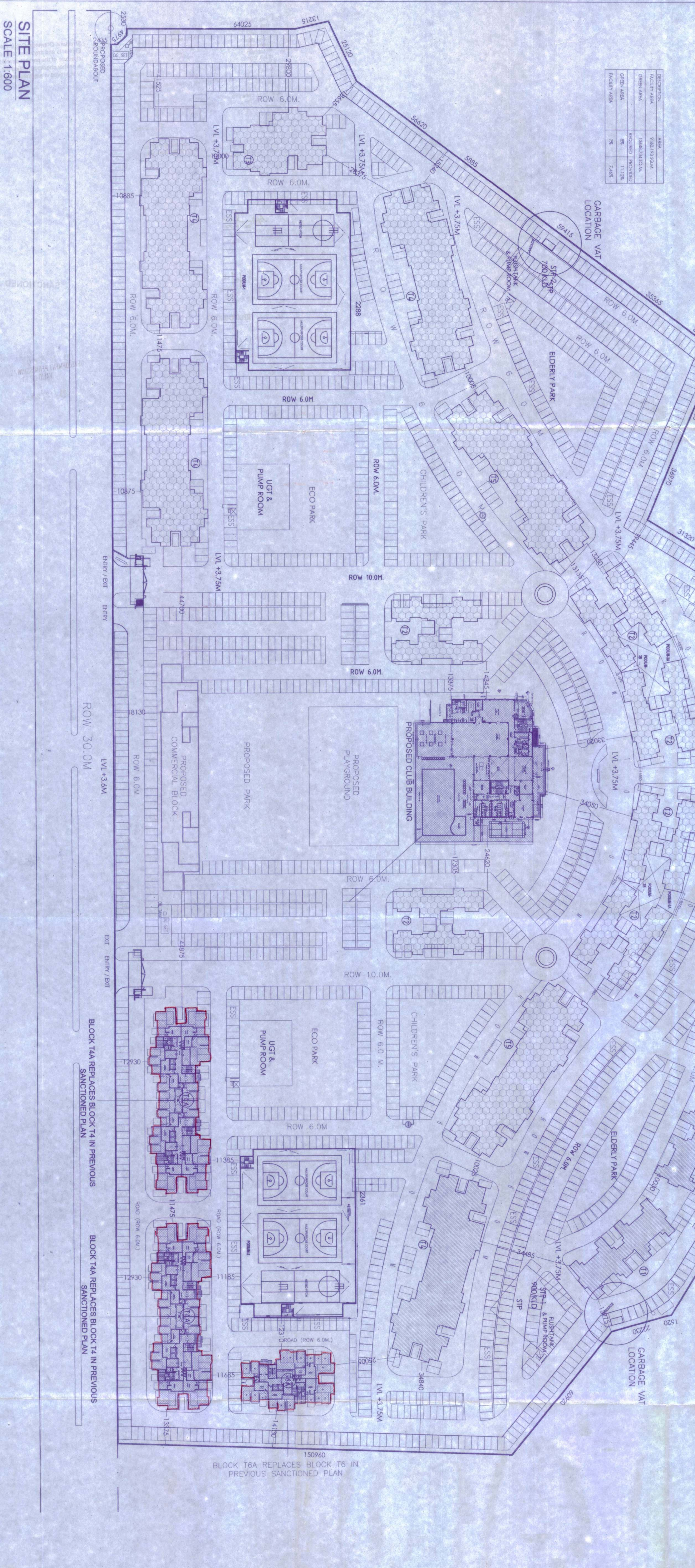

SL	Building Type	No. of buildings	Status as on date	Legend	Sanctioned on
1	TOWER-1	2	Sanctioned and under construction	[Pattern]	24.09.15
2	TOWER-1	3	Sanctioned but not constructed	[Pattern]	24.09.15
3	TOWER-2	6	Sanctioned but not constructed	[Pattern]	24.09.15
4	TOWER-3	1	Sanctioned but not constructed	[Pattern]	24.09.15
5	TOWER-4	1	Sanctioned and under construction	[Pattern]	24.09.15
6	TOWER-4	3	Sanctioned but not constructed	[Pattern]	24.09.15
7	TOWER-4A	2	Sanctioned but not constructed	[Pattern]	24.09.15
8	TOWER-5	2	Sanctioned but not constructed	[Pattern]	24.09.15
9	TOWER-6A	1	Sanctioned and New	[Pattern]	24.09.15
10	CLUB	1	Revised and New	[Pattern]	24.09.15

PROJECT:
REVISED 9 NOS. G+20 RESIDENTIAL BUILDINGS (TOWERS 7A AND 7B) AND 1 NO. G+1 CLUB BUILDING WITHIN PROPOSED AFFORDABLE HOUSING PROJECT AT PLOT R2B OF KVIC, HOWRAH

CLIENT:
KOLKATA WEST INTERNATIONAL CITY SALAP MORE, HOWRAH

ARCHITECT:
MSBA SPECTRA

DATE: 31.07.2019

SCALE: 1:600

REVISION:

CHD

APPROVED: [Signature]

DATE: 24/09/2015

PROJECT NO.: 24/09/2015

SCALE: 1:600

DATE: 31.07.2019

REVISION:

CHD

1. This Development Permission is valid for a period of Five Year from the date of signing by appropriate Authority.
2. This Development Permission does not cover any subsequent construction details and/or elements and/or structures which are not shown in the sub and superstructure and structural drawings of the project.
3. The Development Permission does not entitle the Developer to obtain any sanction from any other authority or agency.
4. All local, township, utility, connection and any other Land/Law related matter as may be applicable to the project shall be to be checked and verified by the Local Body/Authority.
5. The Developer shall be responsible for the disposal of the Waste, Sewage, Storm Water disposal and other services as may be required by the Local Body/ Govt. Dept. concerned in respect of the development of Land.
6. This Development Permission is being recommended without any prejudice and in consultation of any other Regulatory Authority, as the case may be.

Structural Drawings, Calculations, Elements and any issue related to structure of the present development is neither checked/verified nor vetted or approved in any manner by KMDA.

Approved
16/12/20
Assistant Planner
LAPC (EB) / S. P. Unit
K.M.D.A.

16/12/20
By Director of Planning
LAPC (EB) / S. P. Unit
K.M.D.A.

RECOMMENDED
16/12/20
Director of Planning
Statutory Planning Unit
K.M.D.A.

SANCTIONED

01/12/2021
DEVELOPMENT PERMISSION/SANCTION
VALID UP TO
01/12/2021

Sl. No.	Particulars	Area (sq. m)	Volume (cu. m)
1	LOWER-1	10000	10000
2	LOWER-2	10000	10000
3	LOWER-3	10000	10000
4	LOWER-4	10000	10000
5	LOWER-5	10000	10000
6	LOWER-6	10000	10000
7	LOWER-7	10000	10000
8	LOWER-8	10000	10000
9	LOWER-9	10000	10000
10	LOWER-10	10000	10000
11	LOWER-11	10000	10000
12	LOWER-12	10000	10000
13	LOWER-13	10000	10000
14	LOWER-14	10000	10000
15	LOWER-15	10000	10000
16	LOWER-16	10000	10000
17	LOWER-17	10000	10000
18	LOWER-18	10000	10000
19	LOWER-19	10000	10000
20	LOWER-20	10000	10000

SCALE: 1:1000
K.M.D.A.



K.M.D.A.
KORVAVA AREA

SECRETARY

OFFICE OF THE
SECRETARY
K.M.D.A.
KORVAVA AREA